

LOCATED IN THE SOUTHEAST QUARTER OF SECTION 1, TOWNSHIP 3 SOUTH, RANGE 66 WEST
 OF THE SIXTH PRINCIPAL MERIDIAN, AND THE SOUTHWEST QUARTER OF SECTION 6,
 TOWNSHIP 3 SOUTH, RANGE 65 WEST OF THE SIXTH PRINCIPAL MERIDIAN,
 CITY OF AURORA, COUNTY OF ADAMS, STATE OF COLORADO

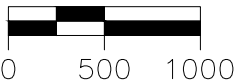
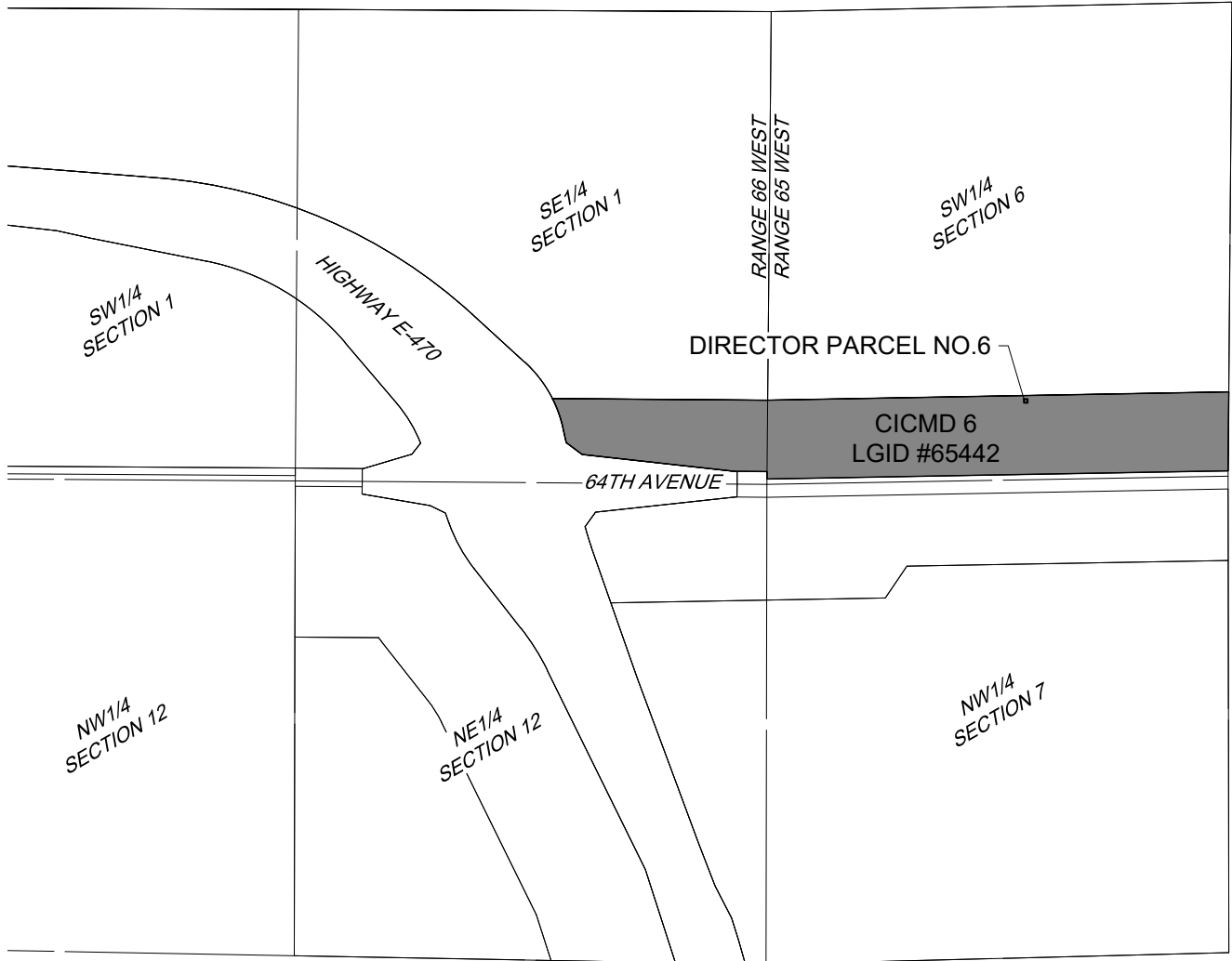

SCALE: 1"=1000'
 ALL LINEAL
 DIMENSIONS ARE IN
 U.S. SURVEY FEET

COLORADO INTERNATIONAL CENTER
METROPOLITAN DISTRICT NO 6
BOUNDARY

JANUARY 4, 2021



12499 WEST COLFAX AVENUE, LAKEWOOD, COLORADO 80215
 303.431.6100 MARTINMARTIN.COM